

Accessory part

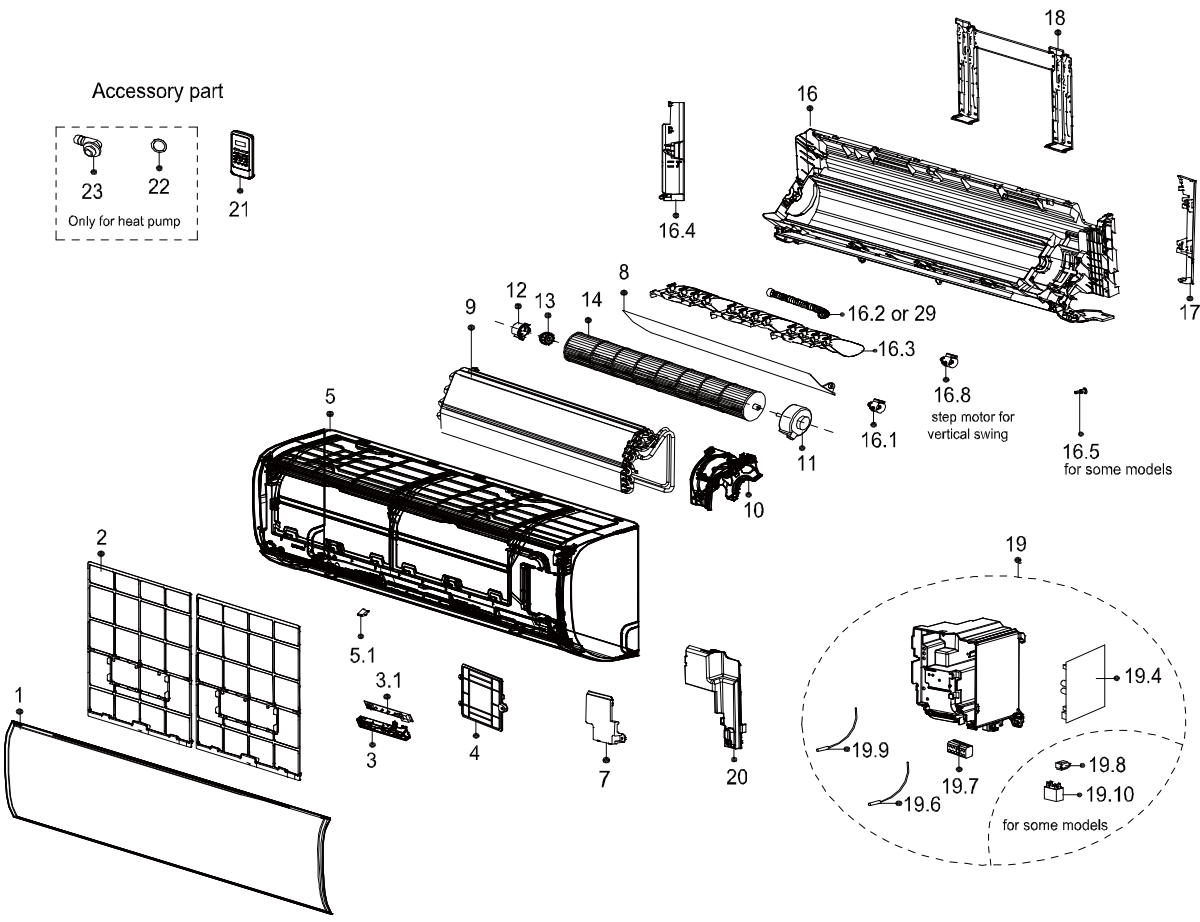

Optional part

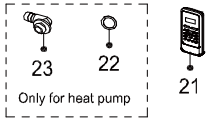
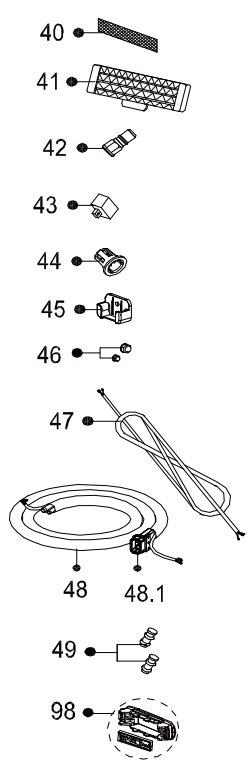

### Exploded View

产品编码(Product model) :  
 客户编码(Customer No) :  
 客户型号(Customer model) :  
 订单编码(Order Product Code) :

22022011012359  
 G0011405  
 KWX-24HRHI  
 62220-J2612103

EX_ID	Spare Parts Code	Part Name(CN)	Part Name(EN)	Qty.	Remark2	Part Status	Drawing No	MIN_ORDE R_QTY	Long Term Material(Y or N)	High Rate of Replacemen t(Y or N)	SB Type	Replace Type	Remarks
1	12122000A84108	面板部件	Panel assembly	1		In Use	KAISAI-KF70G/N1Y-AF9.1-0103	1					
2	12122000015222	过滤网	Filter	2		In Use	SA-KFR70G/N1Y-AFD-6A	1					
3	17222000A66671	外销分体显示盒组件	Display box subassembly	1		In Use	CE-KFR35G/N1Y-AF9.D.01.XK1.3(XK/W/f)						
3.1	17122000038028	外销分体显示板组件	Display board subassembly	1		In Use	EU-KFR26G/N1Y- MA_JD.GN.WX.XS.XS2.22(XK)	1					
4	12122000013357	电器盖板	Cover Plate	1		In Use	SA-KFR70G/N1Y-AFD-5	1					
5	12122000013353	面框部件	Panel Frame Assembly	1		In Use	SA-KFR70G/N1Y-AFD.2	1					
5.1	12122000013355	螺钉盖	Screw Cap	2		In Use	SA-KFR70G/N1Y-AFD.2-2	1					
7	12122000013350	接线盖防护组件	Cover of electrical equipment subassembly	1		In Use	SA-KFR70G/N1Y-AFD.6	1					
8	12122000013348	导风板	Louver	1		In Use	SA-KFR70G/N1Y-AFD-1	1					
9	15822000008192	蒸发器部件	Evaporator Assembly	1		In Use	SA-KF70G/N1Y-AFD(B8)(15U).ZL(J)	1					
10	12122000013349	电机盖	Motor Cover	1		In Use	SA-KFR70G/N1Y-AFD-9	1					
11	11002015008646	无刷直流电机	Brushless DC Motor	1		In Use	ZKFP-58-8-1-5	1					11002015A0117
12	12122000000350	轴承座套	Bearing Holder	1		In Use	ZCZT-01	1					
13	12622000000131	轴承座组件	Bearing components	1		In Use	ZCZZJ-01	1					12622000A0000
14	12100102000002	贯流风轮	Cross Flow Fan	1		In Use	GL-107.5*780-IN	1					12100102A0014
16	12122000020047	室内机底盘部件	Chassis assembly	1		In Use	SA-KFR70G/N1Y-AFD.3A	1					
16.1	11002010000049	步进电机	Stepper Motor	1		In Use	SM-30-17-12-14	1					
16.2	12100501000032	出水喉	Drain Hose	1		In Use	KFR-26G/BP2DN1Y-IC-10	1					
16.3	12122000015023	百叶	Horizontal louver	12		In Use	SA-KFR70G/N1Y-AFD.3-5	1					
16.4	12122000013342	底盘前盖板(左)	Front cover of chassis(left)	1		In Use	SA-KFR70G/N1Y-AFD.3-3	1					
16.5	12122000000344	防电轴(本色,POM)	Insulated Axis	1		In Use	EU-KFR35G/BP3N1Y-1A.1-1	1					
16.6	12622000000030	排水塞	Drainage plug	1		In Use	PSS-02	1					
16.8	11002010000161	步进电机	Stepper Motor	1		In Use	SM-24-19-16-42	1					
17	12122000013346	配管压板	pipe clamp board	1		In Use	SA-KFR70G/N1Y-AFD.2	1					
18	12222000005965	室内机安装板	Installation Plate	1		In Use	SA-KFR70G/N1Y-AFD.4	1					
19	17222000034345	外销分体室内电控盒组件(中低端)	Electronic Control Box Subassembly (Mid-and Low-End)	1		In Use	EU-KFR70G/BP3N1Y-AFD- W_JD.GN.WXNK.DK2.1(R32/EE1/NEW_ERR)	1					
19.4	17122000052104	外销分体室内主控板组件	Main Control Board Subassembly	1		In Use	EU-KFR70G/BP3N1Y-AFD- W_JD.GN.WXNK.NK2.1(R32/EE1/NEW_ERR)	1					
19.6	11201007003447	管温传感器	Pipe Temperature Sensor	1		In Use	CGO-WD/GW4100-L350-XACP2-P250	0					
19.7	17400401000006	接线座(5位)(漏峰)	Terminal	1		In Use	JXZ-AD5J(UL)/C(YF2004C)	1					
19.9	11201007003424	室温传感器	Room Temperature Sensor	1		In Use	CGO-WD/SW4100-L350-XHBCP2BL-P300- HT1.0	0					
20	12122000013356	电控盒盖组件	Electrical Control Box Cover Subassembly	1		In Use	SA-KFR70G/N1Y-AFD.7	1					
21	17317000A61204	订单遥控器	Remote controller	1		In Use	RG10B(F)/BGEF	1					
22	12600701000039	密封胶	seal ring	1		In Use	KC25B.4-8A	1					
23	12100509000061	出水接管	Drain Hose	1		In Use	CSJG-1	1					
40	12100204000685	冷触媒过滤网	Air Freshening Filter	1		In Use	KFR-23G/AY.1-10	1					
40	12100207000136	HEPA网	High Efficiency Particulate Air Filter	1		In Use	KFR-23G/IY.1-14A	1					12100207000136
45	12122000029201	遥控器安装支架组件	Bracket of remote Controller	1		In Use	RG10ZJ-1	1					
46	15500406000003	铜螺母	Copper nut	1	A01=6.3 5mm(1/4 in);B02= 9.52mm( 3/8in);C 03=12.7 mm(1/2 in);D04= 15.9mm( 5/8in);E0 5=19mm (3/4in);F 07=22m m(7/8in);	In Use	TLM-D04	0	N	N			

46	1550040600010	铜螺母	Copper nut	1	A01=6.35mm(1/4 in);B02=9.52mm(3/8in);C03=12.7mm(1/2 in);D04=15.8mm(5/8in);E05=19mm(3/4in);F07=22mm(7/8in);	In Use	TLM-B02	0	N	N	SB011738	1550040600015
98	17310900A06289	WiFi模块组件	WiFi module subassembly	1		In Use	EU-OSK105.JD.TY.MWLN.NET	1				