

# Optional function parts

- 39
- 40
- 41
- 42
- 43
- 98
- 99

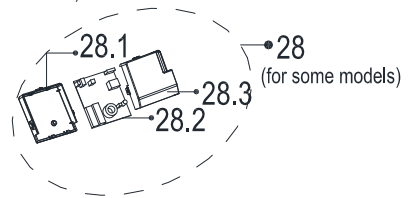
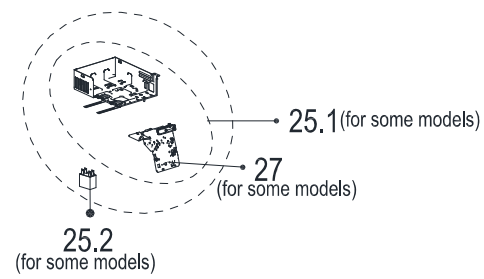
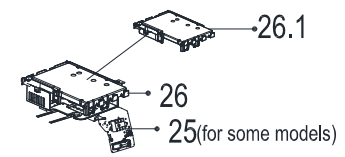
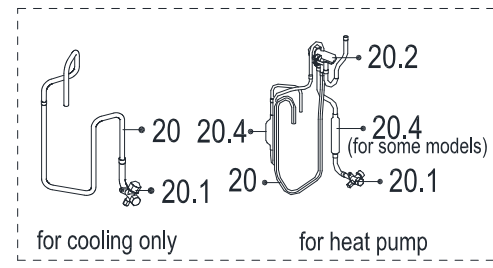
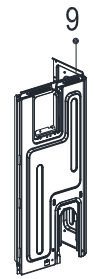
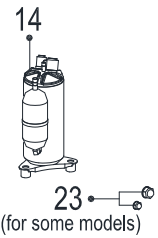
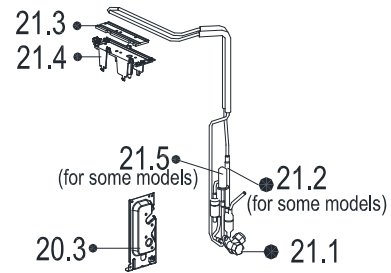
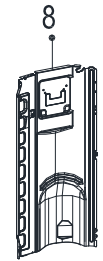
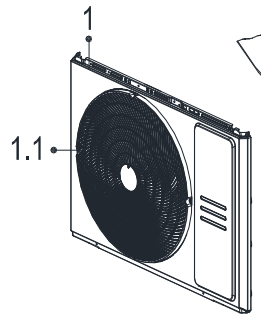
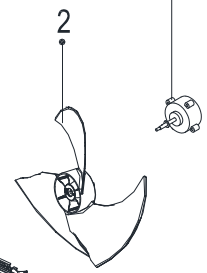
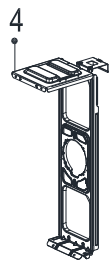
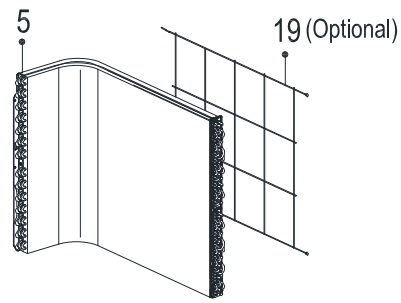
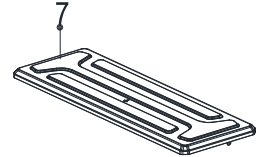

# Optional function parts

- 39
- 40
- 41
- 42
- 43
- 98
- 99

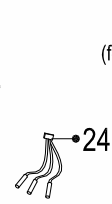
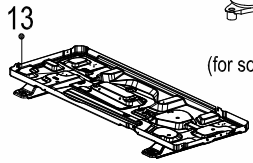
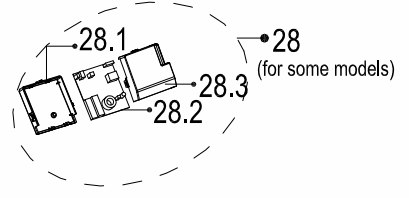
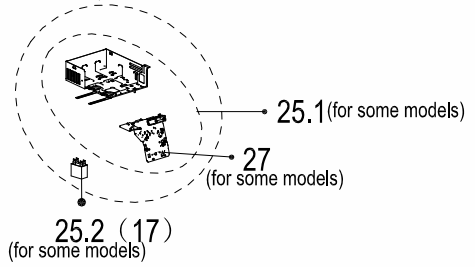
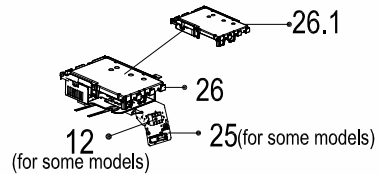
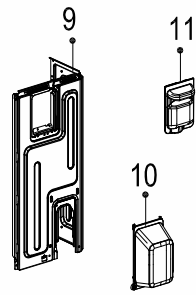
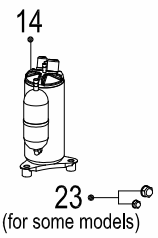
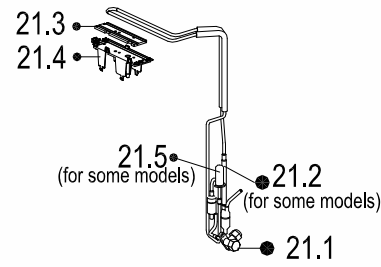
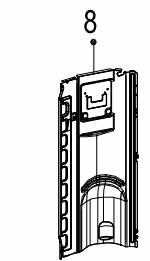
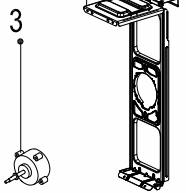
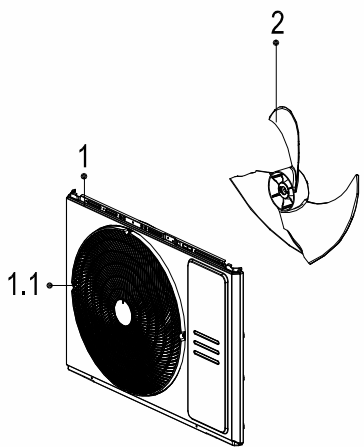
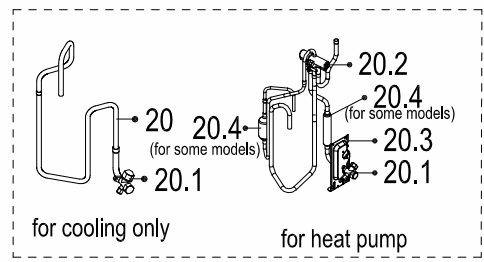
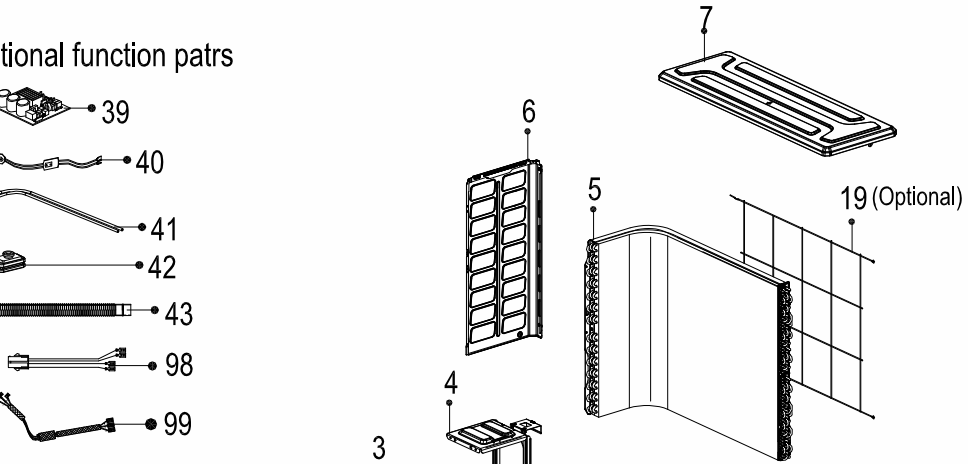

### Exploded View

产品编码(Product model) : 22022016016820  
 客户编码(Customer No) : G0011405  
 客户型号(Customer model) : KWX-24HRGO  
 订单编码(Order Product Code) : 62220-D6595108

EX_ID	Spare Parts Code	Part Name(CN)	Part Name(EN)	Qty.	Remark2	Part Status	Drawing No	MIN_ORDER_QTY	Long Term Material(Y or N)	High Rate of Replacement(Y or N)	SB Type	Replace Type	Remarks
1	12222000013505	前面板部件	Front panel	1		In Use	WX401.BJ.6	1					
1.1	12122000026421	出风网罩	Air outlet grille	1		In Use	WX401.SL.1	1					
2	12100105000841	轴流风叶 RoHS ZL-535*133*12-3KFN	Axial flow fan	1		In Use	ZL-535*133*12-3KFN	1					
3	11002015000366	无刷直流电机 RoHS ZKFN-80-8-3 310V	Brushless DC Motor	1		In Use	ZKFN-80-8-3						
4	12222000012371	电机支架 RoHS KFR-72W-X401.3-1	Supporter of fan motor	1		In Use	KFR-72W-X401.3-1	1					
5	15822000009836	冷凝器部件	Condenser assembly	1		In Use	KFR-72W/BP3N8-X401.JC.ZL.1B	1					
6	12222000012929	左侧板 卡其MS-YE051-P01 RoHS KFR-72W-X401.4-1A	Left supporter	1		In Use	KFR-72W-X401.4-1A	1					
7	12222200005737	顶盖部件 SB2098 RoHS KFR-72W-X401.7	Top cover assembly	1		In Use	KFR-72W-X401.7	1					
8	12222000013245	隔板部件 RoHS,REACH KFR-72W-X401.2	Partition board assembly	1		In Use	KFR-72W-X401.2	1					
9	12222000012930	右侧板部件	Right clapboard assembly	1		In Use	KFR-72W-X401.5A	1					
10	12122000007150	接水盘	Water collector	1		In Use	BA01.SL-2	1					
11	12122000024624	大把手(BMC) NumberRE-YE051 RoHS KFR-72W-X401.6-1A	Big handle(BMC)	1		In Use	KFR-72W-X401.6-1A	1					
12	17400401000016	接线座(6位) RoHS JXZ-PG6H-A	Terminal	1		In Use	JXZ-PG6H-A	1					
13	12222000013507	底盘部件	Chassis Assembly	1		In Use	WX401.BJ.1B	1					
14	11103020006879	变频旋转式压缩机 KTM240D43UKT	DC Inverter rotary compressor	1		In Use	KTM240D43UKT						
20	15422000018832	四通阀部件	4-way valve assembly	1		In Use	EU-KFR70W/BP3N8-X401(RD0).ZL.1	1					
20.1	15500204000502	低压阀	Gas valve	1		In Use	DYF-C16N2	1					
20.2	15500216000026	四通阀(R410A,线长450,VHR连接器) RoHS STF-02BN1(VHR) R410A 线长450 VHR连接器	4-way Valve	1		In Use	STF-02BN1(VHR)	1					
20.3	12222200005738	阀安装板 MS-YE051-P01 RoHS KFR-72W-X401-1	Valve plate	1		In Use	KFR-72W-X401-1	1					
20.4	15122000027116	消声器部件 RoHS KFR-72W/BP3N8-X401.JC.ZL.2.1A(GT)	Muffler subassembly	1		In Use	KFR-72W/BP3N8-X401.JC.ZL.2.1A(GT)						
20.4	15122000027161	消声器部件 REACH,RoHS EU-KFR70W/BP3N8-X401(RD0).ZL.1.1(GT)	Muffler subassembly	1		In Use	EU-KFR70W/BP3N8-X401(RD0).ZL.1.1(GT)						
21	15422000017892	高压阀部件 RoHS EU-KFR70W/BP3N8-X401(RD0)-GW.ZL.1	Liquid valve Assembly	1		In Use	EU-KFR70W/BP3N8-X401(RD0)-GW.ZL.1	1					
21.1	15500208000286	高压阀 REACH,RoHS GYF-C27N	Liquid valve	1		In Use	GYF-C27N						
21.2	15500210001668	节流阀	Throttle valve	1		In Use	JLF(G)-042-N8-N6	1					
21.2	15500210000588	节流阀 RoHS JLF(G)-038-N8-N6	Throttle valve	1		In Use	JLF(G)-038-N8-N6	1					
21.3	11203803001176	散热器 REACH,RoHS SRQ155.2*37.9*5.3-AIQ80g-N	Radiator	1		In Use	SRQ155.2*37.9*5.3-AIQ80g-N	1					
21.4	12122000011478	U型铜管支撑 RoHS C01.DKH.SL-1 冷媒散热	U-Typed Support with Copper Pipe	1		In Use	C01.DKH.SL-1	1					

23	15500406000003	铜螺母 RoHS TLM-D04	Copper nut	1	A01=6.35mm(1/4in);B02=9.52mm(3/8in);C03=12.7mm(1/2in);D04=15.9mm(5/8in);E05=19mm(3/4in);F07=22mm(7/8in)	In Use	TLM-D04	0	N	N			
23	15500406000010	铜螺母 RoHS TLM-B02	Copper nut	1	A01=6.35mm(1/4in);B02=9.52mm(3/8in);C03=12.7mm(1/2in);D04=15.9mm(5/8in);E05=19mm(3/4in);F07=22mm(7/8in)	In Use	TLM-B02	0	N	N			
24	11201011000188	组合传感器 RoHS CGQ-ZH-GW/SW/PQ-L1100-XH-P900-3(CH)	Combination sensor	1		In Use	CGQ-ZH-GW/SW/PQ-L1100-XH-P900-3(CH)	1					
25	17222000031763	电控盒端子板组件	Terminal board subassembly	1		In Use	KFR-72W/BP3N8-X401.JD.TY.BDZ.DZ1.2-1B	1					
26	17222000034346	外销变频室外电控盒组件	Electronic control box subassembly	1		In Use	EU-KFR70W/BP3N8-X431(LMG+PD22020AZ1+KTM240D43UKT+RX24Tmini+6MBP30XSF060+6822).JD.FW.WXWKB.DK1(AGWL)	1					
26.1	12122000008999	电控安装盒 RoHS KFR-26W/BP2N1-J181.D.13.DK1.1.1-1A	Electronic installing box	1		In Use	KFR-26W/BP2N1-J181.D.13.DK1.1.1-1A	1					
99	17401203012697	压缩机连接组 RoHS PXQ-YSJ200RD/190BL/210BK-14#PA66	Compressor wire subassembly	1		In Use	PXQ-YSJ200RD/190BL/210BK-14#PA66	1					