

Accessory part

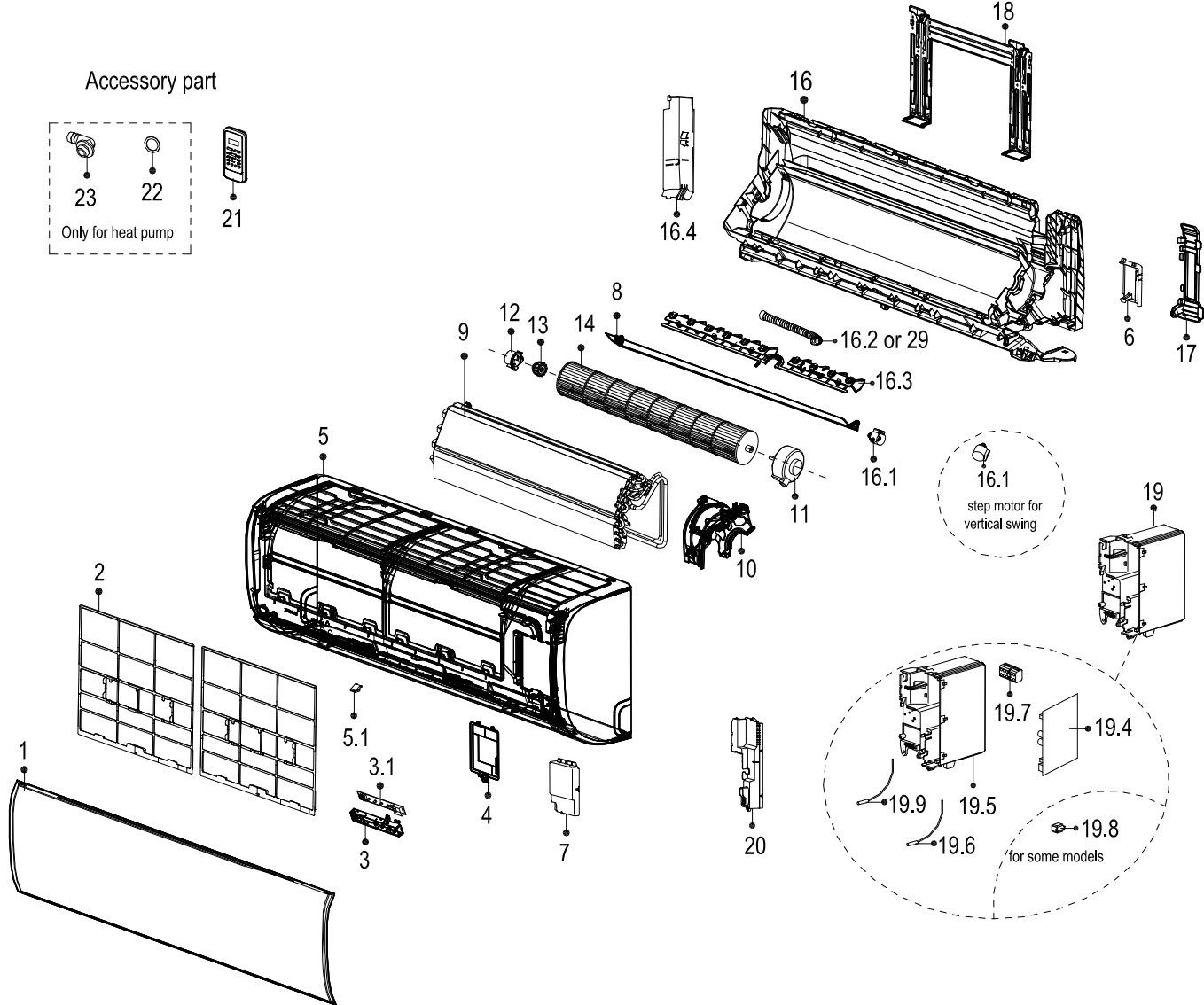

Optional part

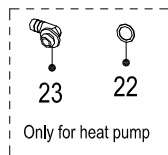
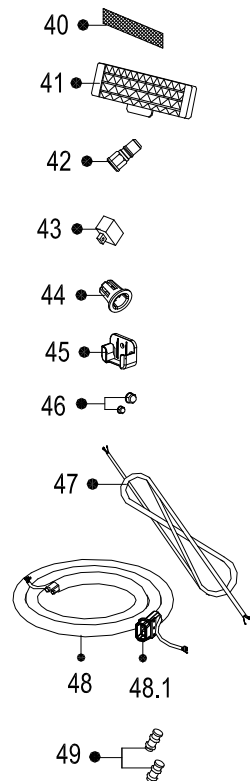

Accessory part

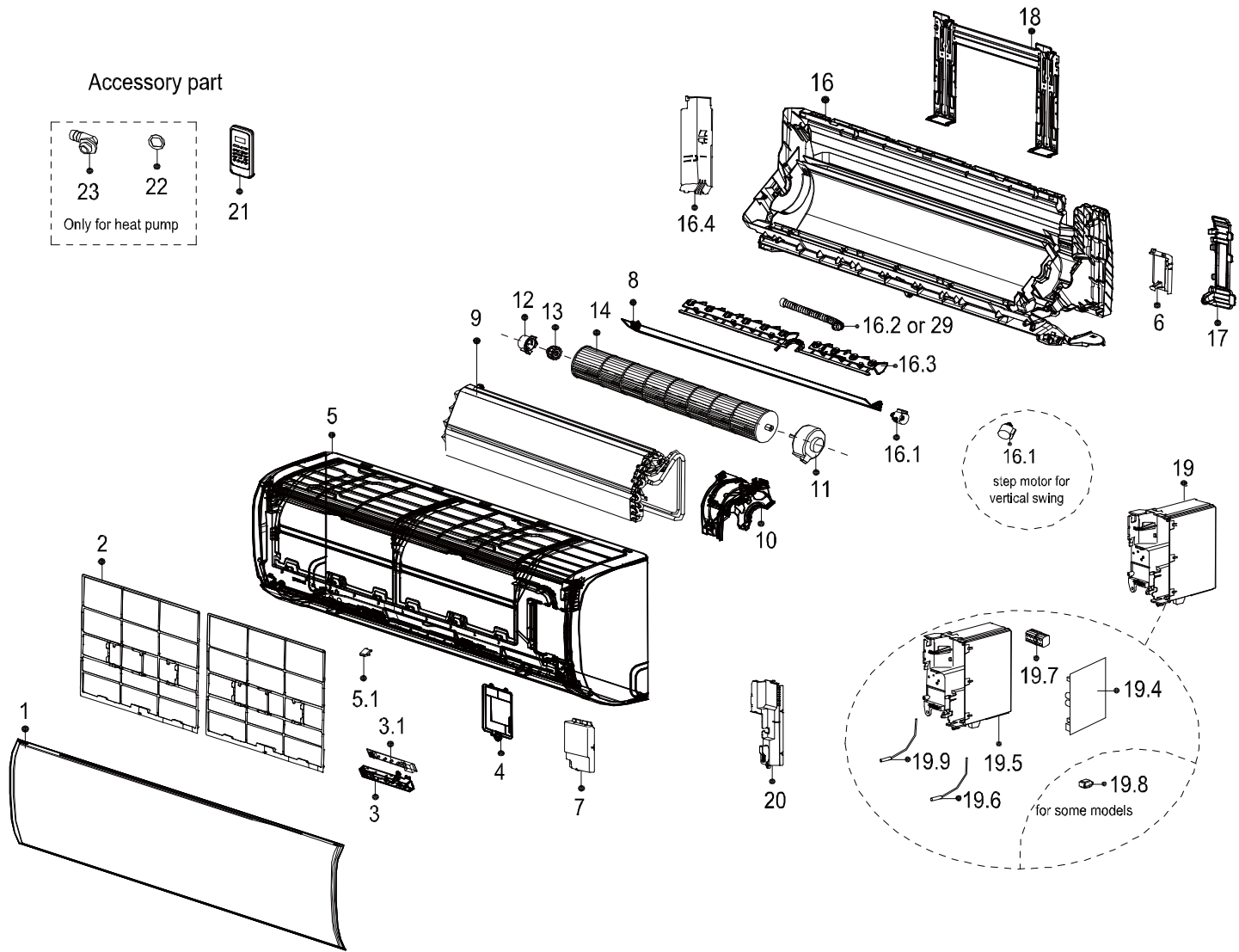
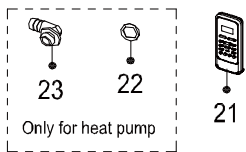

Optional part

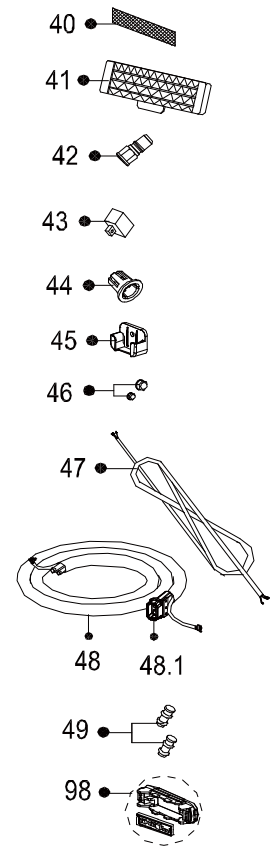

Exploded View

产品编码(Product model) : 22022011012358
 客户编码(Customer No) : G0011405
 客户型号(Customer model) : KWX-18HRGI
 订单编码(Order Product Code) : 62220-D6595105

EX_ID	Spare Parts Code	Part Name(CN)	Part Name(EN)	Qty.	Remark2	Part Status	Drawing No	MIN_ORDER_QTY	Long Term Material(Y or N)	High Rate of Replacement(Y or N)	SB Type	Replace Type	Remarks
1	12122000A83977	面板部件	Panel assembly	1		In Use	KAISAI-KF53G/N1Y-AF9.1-0103	1					
2	12100204001559	过滤网 PAHs,REACH,RoHS SA-KF53G/N1Y-MA-3	Air filter	2		In Use	SA-KF53G/N1Y-MA-3	1					
3	17222000A46336	外销分体显示盒组件	Display box subassembly	1		In Use	CE-KFR35G/N1Y-AF9.D.01.XK1.2(WIFI)						
3.1	17122000053593	外销分体显示板组件 RoHS EU-KFR26G/N1Y-AF.JD.GN.WXXS.XS2.1(XK/908) 带红外线控制器插口 CN2.908芯	Display board subassembly	1		In Use	EU-KFR26G/N1Y-AF.JD.GN.WXXS.XS2.1(XK/908)						
4	12122000013131	电器盖板	Cover of electrical equipment	1		In Use	SA-KF35G/N1Y-AF-7	1					
5	12122000013179	面框部件 S1022 RoHS SA-KF53G/N1Y-AF.3	Panel frame assembly	1		In Use	SA-KF53G/N1Y-AF.3						
5.1	12122000013139	螺钉盖	Screw Cap	2		In Use	SA-KF35G/N1Y-AF.2-2	1					
6	12122000013175	底盖前盖板(右) 钛钢灰RE-GY103 RoHS,PAHs,REACH SA-KF53G/N1Y-AF-4	Front cover of chassis(right)	1		In Use	SA-KF53G/N1Y-AF-4	1					
7	12122000013141	接线盖防护组件	Cover of electrical equipment subassembly	1		In Use	SA-KF35G/N1Y-AF.7	1					
8	12122000013187	导风板 S1022 RoHS,PAHs,REACH SA-KF53G/N1Y-AF-6	Horizontal louver	1		In Use	SA-KF53G/N1Y-AF-6						
9	15822000008160	蒸发器部件 REACH,RoHS CE-KFR53G/N1Y-MA(C2).ZLGL(J) 7- 14U 浅金色	Evaporator assembly	1		In Use	CE-KFR53G/N1Y-MA(C2).ZLGL(J)	1					
10	12122000013176	电机盖 本色 RoHS SA-KF53G/N1Y-AF-5 取销鱼母	Fan motor cover	1		In Use	SA-KF53G/N1Y-AF-5	1					
11	11002015011867	无刷直流电机 RoHS ZKFP-30-8-3-10 310V	Brushless DC Motor	1		In Use	ZKFP-30-8-3-10						
12	12122000000350	轴承座套 RoHS ZCZT-01	Bearing holder	1		In Use	ZCZT-01	1					
13	12622000000131	轴承座组件 RoHS ZCZZJ-01	Bearing components	1		In Use	ZCZZJ-01	1					
14	12100102000131	贯流风轮 RoHS,REACH GL-98*758-1 配AB/MB机型生产	Cross flow fan	1		In Use	GL-98*758-1	1					
16	12122000A27214	室内机底盖部件	Chassis assembly	1		In Use	SA-KF53G/N1Y-AF.1B	1					
16.1	11002010000161	步进电机 RoHS SM-24-19-16-42 /MP24GA16	Stepper motor	1		In Use	SM-24-19-16-42						
16.1	11002010000143	步进电机 RoHS SM-24-19-16-8	Stepper motor	1		In Use	SM-24-19-16-8						
16.2	12100501000032	出水喉 RoHS KFR-26G/BP2DN1Y-IC-10	Drain hose	1		In Use	KFR-26G/BP2DN1Y-IC-10	1					
16.3	12122000019581	百叶	Horizontal louver	12		In Use	CE-KFR53G/N1Y-AE.3B-3	1					
16.4	12122000013186	底盖前盖板(左) 钛钢灰RE-GY103 RoHS,PAHs,REACH SA-KF53G/N1Y-AF.1-3	Front cover of chassis(left)	1		In Use	SA-KF53G/N1Y-AF.1-3	1					
16.5	12122000000344	防电轴(本色,POM) RoHS EU-KFR35G/BP3N1Y-1A.1-1 (本色,POM)	Insulated axis	1		In Use	EU-KFR35G/BP3N1Y-1A.1-1	1					
17	12122000013178	配管压板 RE-GY103(钛钢灰) RoHS,REACH SA-KF53G/N1Y-AF-2	pipe clamp board	1		In Use	SA-KF53G/N1Y-AF-2	1					
18	12222000005866	室内机安装板 RoHS SA-KF53G/N1Y-AF.7 10.8	Installation plate	1		In Use	SA-KF53G/N1Y-AF.7	1					
19	17222000034395	外销分体室内电控盒组件(中低端)	Electronic control box subassembly (Mid-and low-end)	1		In Use	EU-KFR50G/BP3N1Y-AFCU(RD0)-GW.JD.GN.WXNK.DK2.3(R32/EE1/NEW_ERR)	1					

19.4	17122000052164	外销分体室内主控板组件	Main control board subassembly	1		In Use	EU-KFR50G/BP3N1Y-AFCU(RD0)-GW.JD.GN.WXNK.NK2.3(R32/EE1/NEW_ERR)						
19.5	12122000013001	电控盒结构组件	Electronic control box subassembly	1		In Use	SA-KF35G/N1Y-AF.9	1					
19.6	11201007003447	管温传感器 REACH,RoHS CGQ-WD/GW4100-L350-XACP2-P250	Pipe Temperature Sensor	1		In Use	CGQ-WD/GW4100-L350-XACP2-P250						
19.7	17400401000094	接线座(整改,原编码 2230145023)(中込/源峰/凯都/静裕)	Terminal	1		In Use	JXZ-AD5Z-A(RS9103C-5/YF2004/JX-PF-5/JGD-ZR5-P-1)	1					
19.9	11201007003424	室温传感器 REACH,RoHS CGQ-WD/SW4100-L350-XHBCP2BL-P300-HT1.0	Room Temperature Sensor	1		In Use	CGQ-WD/SW4100-L350-XHBCP2BL-P300-HT1.0						
20	12122000013132	电控盒盖组件	Electrical Control Box Cover Subassembly	1		In Use	SA-KF35G/N1Y-AF.8	1					
21	17317000A57288	订单遥控器	Remote controller	1		In Use	RG66A1/BGEF	1					
22	12600701000039	密封圈 RoHS KC25B.4-8A	seal ring	1		In Use	KC25B.4-8A	1					
23	12100509000061	出水接管 RoHS CSJG-1	Drain hose	1		In Use	CSJG-1	1					
40	12100204000685	冷触媒过滤网 RoHS KFR-23G/AY.1-10	Air freshening filter	1		In Use	KFR-23G/AY.1-10	1					
40	12100207000136	HEPA网 RoHS,REACH KFR-23G/IY.1-14A 生物杀菌、北美禁用	High efficiency particulate air filter	1		In Use	KFR-23G/IY.1-14A	1					
45	12122000027144	遥控器安装支架组件 PAHs,REACH,RoHS RG66-ZJ 将12117000002115支架和11303120000020螺钉合并为组件编码	Bracket of remote Controller	1		In Use	RG66-ZJ	1					
46	15500406000012	铜螺母 RoHS TLM-C03	Copper nut	1	A01=6.35mm(1/4in);B02=9.52mm(3/8in);C03=12.7mm(1/2in);D04=15.9mm(5/8in);E05=19mm(3/4in);F07=22mm(7/8in);	In Use	TLM-C03	0	N	N			
46	15500406000016	铜螺母 RoHS TLM-A01	Copper nut	1	A01=6.35mm(1/4in);B02=9.52mm(3/8in);C03=12.7mm(1/2in);D04=15.9mm(5/8in);E05=19mm(3/4in);F07=22mm(7/8in);	In Use	TLM-A01	0	N	N			
98	17310900A06289	WIFI模块组件	WIFI module subassembly	1		In Use	EU-OSK105.JD.TY.MWL.NET	1					