

Optional function parts

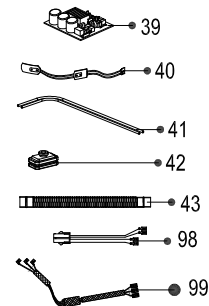

For some models

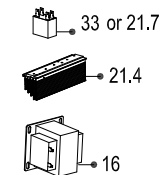

Exploded View

Product code :
Customer model :

22022016012100
KWX-12HRDO

EX_ID	Spare Parts Code	Part Name(EN)	Qty.	Min Shipments	Part Status	Remarks	Long Term Material(Y or N)	High Rate of Replacement(Y or N)	Option Parts
1	11201007002321	Room temperature sensor	1		In use				
2	15822000008149	Condenser assembly	1		In use				
3	11201007002320	Pipe temperature sensor	1		In use				
4	12222000005065	Right clapboard assembly	1		In use				
5	12100701000015	Big handle assembly	1		In use				
6	12122000007150	Water collector	1		In use				
7	12222000005064	Chassis assembly	1		In use				
8	12222000005067	Front panel assembly	1		In use				
9	12122000020241	Air outlet grille	1		In use				
10	12100105000721	Axial flow fan	1		In use				
11	11002015000039	Brushless DC Motor	1	0	In use		N	Y	
12	12222000005068	Supporter subassembly of fan motor	1		In use				
13	12222000005066	Left supporter	1		In use				
14	12222000005072	Top cover assembly	1		In use				
15	12222000005223	Partition board	1		In use				
17	15422000016592	4-way valve assembly	1		In use				
17.1	15500204000014	Gas valve	1		In use				
17.2	15500216000028	4-way valve	1	0	In use		N	Y	
18	15422000014292	Liquid valve assembly	1		In use				
18.1	15500208000028	Liquid valve	1		In use				
18.4	12222000002571	Valve plate	1		In use				
19	11103020000279	DC Inverter Rotary Compressor	1		In use				
20	11201007000005	Discharge temperature sensor	1	0	In use		N	Y	
21	17222000029342	Electronic control box subassembly	1		In use				
21.2	17122000046231	Outdoor main control board subassembly	1		In use				
21.2.1	12222000001455	Cover of electronic control box	1		In use				

21.2.2	12122000006913	Support of electronic control box	1		In use			
21.5	12222000001311	Electronic installing box subassembly	1		In use			
21.10	12122000007073	Fixing board	1		In use			
22	15500406000010	Copper nut	1	0	In use		N	N
22	15500406000016	Copper nut	1	0	In use		N	N
31	12222000008106	Support of electronic control box	1		In use			
32	17400401000016	Terminal	1		In use			
99	17401203000802	Compressor wire subassembly	1		In use			