

Optional function parts

- 38
- 40
- 41
- 42
- 43
- 98
- 99

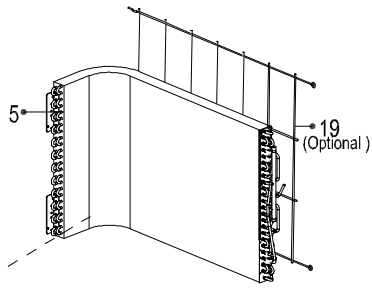

19 (Optional)

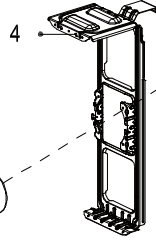
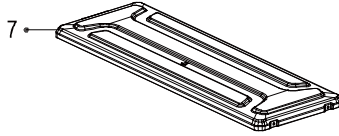
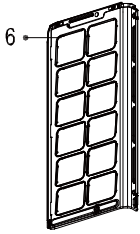
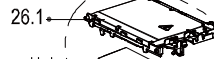
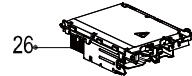
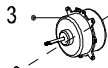
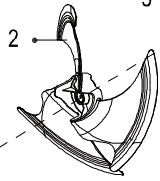

For fully assembled

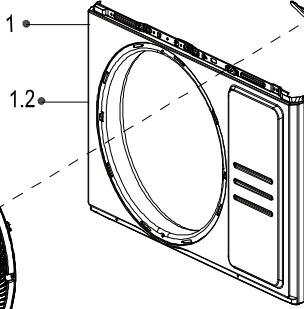
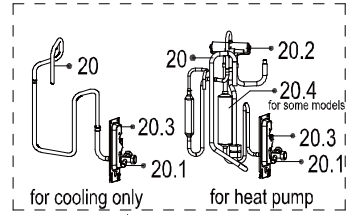
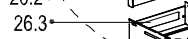
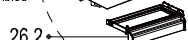

1.2

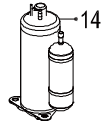
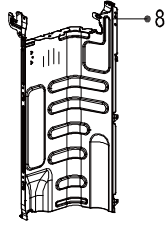

21.2 (for some models)

21

21.1

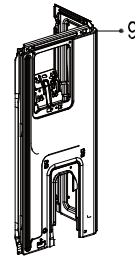

24

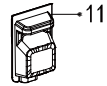

For some models

12

15

16

17

23

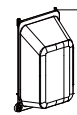
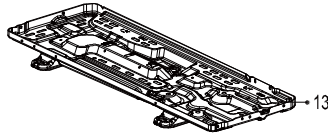
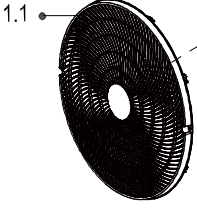

Exploded View

产品编码(Product model) : 22022016016261
 客户编码(Customer No) : G0011405
 客户型号(Customer model) : KLWB-12HRHO
 订单编码(Order Product Code) : 62220-H9529004

| EX_ID | Spare Parts Code | Part Name(CN) | Part Name(EN) | Qty. | Remark2 | Part Status | Drawing No | MIN_ORDE_R_QTY | Long Term Material(Y or N) | High Rate of Replacement(Y or N) | SB Type | Replace Type | Remarks |
|-------|------------------|---------------|---------------------------------------|------|---|-------------|---|----------------|----------------------------|----------------------------------|---------|--------------|---------|
| 1 | 12222000013304 | 前面板部件 | Front panel assembly | 1 | | In Use | WX201.BJ.1 | 1 | | | | | |
| 1.1 | 12122000026241 | 出风网罩 | Air outlet grille | 1 | | In Use | WX301.SL.2 | 1 | | | | | |
| 1.2 | 12222000013305 | 前面板 | Front panel | 1 | | In Use | WX201.BJ.1-1 | 1 | | | | | |
| 2 | 12100105000961 | 轴流风叶 | Axial flow fan | 1 | | In Use | ZL-421*133*8-3KN | 1 | | | | | |
| 3 | 11002015012128 | 无刷直流电机 | Brushless DC Motor | 1 | | In Use | ZKFN-34-10-1-3 | 1 | | | | | |
| 4 | 12222000013233 | 电机支架 | Supporter of fan motor | 1 | | In Use | WX201.BJ.3 | 1 | | | | | |
| 5 | 15822000010456 | 冷凝器部件 | Condenser assembly | 1 | | In Use | EU-KFR26W/BP3N8Y-X201(RD0)-GW.ZL.2 | 1 | | | | | |
| 6 | 12222000013238 | 左侧板 | Left supporter | 1 | | In Use | WX201.BJ-1 | 1 | | | | | |
| 7 | 12222000013240 | 顶盖部件 | Top cover assembly | 1 | | In Use | WX201.BJ.2 | 1 | | | | | |
| 8 | 12222000013665 | 隔板部件 | Partition board assembly | 1 | | In Use | WX201.BJ.9 | 1 | | | | | |
| 9 | 12222000013225 | 右侧板部件 | Right clapboard assembly | 1 | | In Use | WX201.BJ.4 | 1 | | | | | |
| 10 | 12122000007150 | 接水盖 | Water collector | 1 | | In Use | BA01.SL-2 | 1 | | | | | |
| 11 | 12122000031166 | 大把手部件 | Big handle assembly | 1 | | In Use | WX201.SL.1 | 1 | | | | | |
| 12 | 17400401000016 | 接线座(6位) | Terminal | 1 | | In Use | JXZ-PG6H-A | 1 | | | | | |
| 13 | 12222000013228 | 底座部件 | Chassis assembly | 1 | | In Use | WX201.BJ.5 | 1 | | | | | |
| 14 | 111030200006759 | 变频旋转式压缩机 | DC Inverter Rotary Compressor | 1 | | In Use | KSN98D64UFZ3 | 1 | | | | | |
| 20 | 15422000017852 | 四通阀部件 | 4-way Valve Assembly | 1 | | In Use | EU-KFR26W/BP3N8Y-X201(RD0)-GW.ZL.1 | 1 | | | | | |
| 20.1 | 15500204000021 | 低压阀 | Gas valve | 1 | | In Use | DYF-A28N | 1 | | | | | |
| 20.2 | 15500216001903 | 四通阀 | 4-way valve | 1 | | In Use | STF-01N1 | 1 | | | | | |
| 20.3 | 12222200005738 | 阀安装板 | Valve plate | 1 | | In Use | KFR-72W-X401-1 | 1 | | | | | |
| 20.4 | 15122000026302 | 消声器部件 | Muffler Subassembly | 1 | | In Use | EU-KFR26W/BP3N8Y-X201(RD0)-GW.ZL.1.1(GT) | 1 | | | | | |
| 21 | 15422000018812 | 高压阀部件 | Liquid valve assembly | 1 | | In Use | EU-KFR26W/BP3N8-X230(RD6)-GW.ZL.1 | 1 | | | | | |
| 21.1 | 15500208000028 | 高压阀 | Liquid valve | 1 | | In Use | GYF-A28N | 1 | | | | | |
| 23 | 15500406000010 | 铜螺母 | Copper nut | 1 | A01=6.3 5mm(1/4 in);B02= 9.52mm(3/8in);C 03=12.7 mm(1/2 in);D04= 15.9mm(5/8in);E0 5=19mm (3/4in);F 07=22m m(7/8in) | In Use | TLM-B02 | 0 | N | N | | | |
| 23 | 15500406000016 | 铜螺母 | Copper nut | 1 | A01=6.3 5mm(1/4 in);B02= 9.52mm(3/8in);C 03=12.7 mm(1/2 in);D04= 15.9mm(5/8in);E0 5=19mm (3/4in);F 07=22m m(7/8in) | In Use | TLM-A01 | 0 | N | N | | | |
| 24 | 11201011000067 | 组合传感器 | Combination sensor | 1 | | In Use | CGO-ZH-GW/SW/PQ-L735-XH-P500-3-01 | 1 | | | | | |
| 25 | 12222000002259 | 端子安装板 | Terminal board | 1 | | In Use | BA01.BJ.11 | 1 | | | | | |
| 26 | 17222000A60530 | 外销变频室外电控盒组件 | Electronic control box subassembly | 1 | | In Use | EU-KFR33W/BP3N8-X201(AB/AE/AG/VP_KSN98D64UFZ3_RX24Tmini_SDM15G60_SDH8654_4204)_JD.FW.NXWKB_DK1.1 (AGWL) | 1 | | | | | |
| 26.1 | 12122000024223 | 电器安装板 | Support of electronic control box | 1 | | In Use | WX101.SL-2 | 1 | | | | | |
| 26.2 | 12122000024222 | 固定板 | Fixing board | 1 | | In Use | WX101.SL-3 | 1 | | | | | |
| 26.3 | 12222000012106 | 电控安装盒组件 | Electronic installing box subassembly | 1 | | In Use | WX101.BJ.6 | 1 | | | | | |
| 40 | 17402001000603 | 曲轴电加热带 | Crankcase electric heating strip | 1 | | In Use | DJRD-358A-800-20W-5 | 1 | | | | | |
| 41 | 17402002000464 | 电加热管 | Electric heating tube | 1 | | In Use | DJRG-150W-030-2 | 1 | | | | | |
| 99 | 17401203012697 | 压缩机连接线组 | Compressor wire subassembly | 1 | | In Use | PXQ-YSJ200RD/190BL210BK-14#PA66 | 1 | | | | | |