

### Accessory part

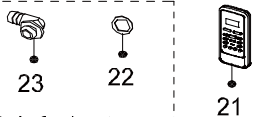

Only for heat pump

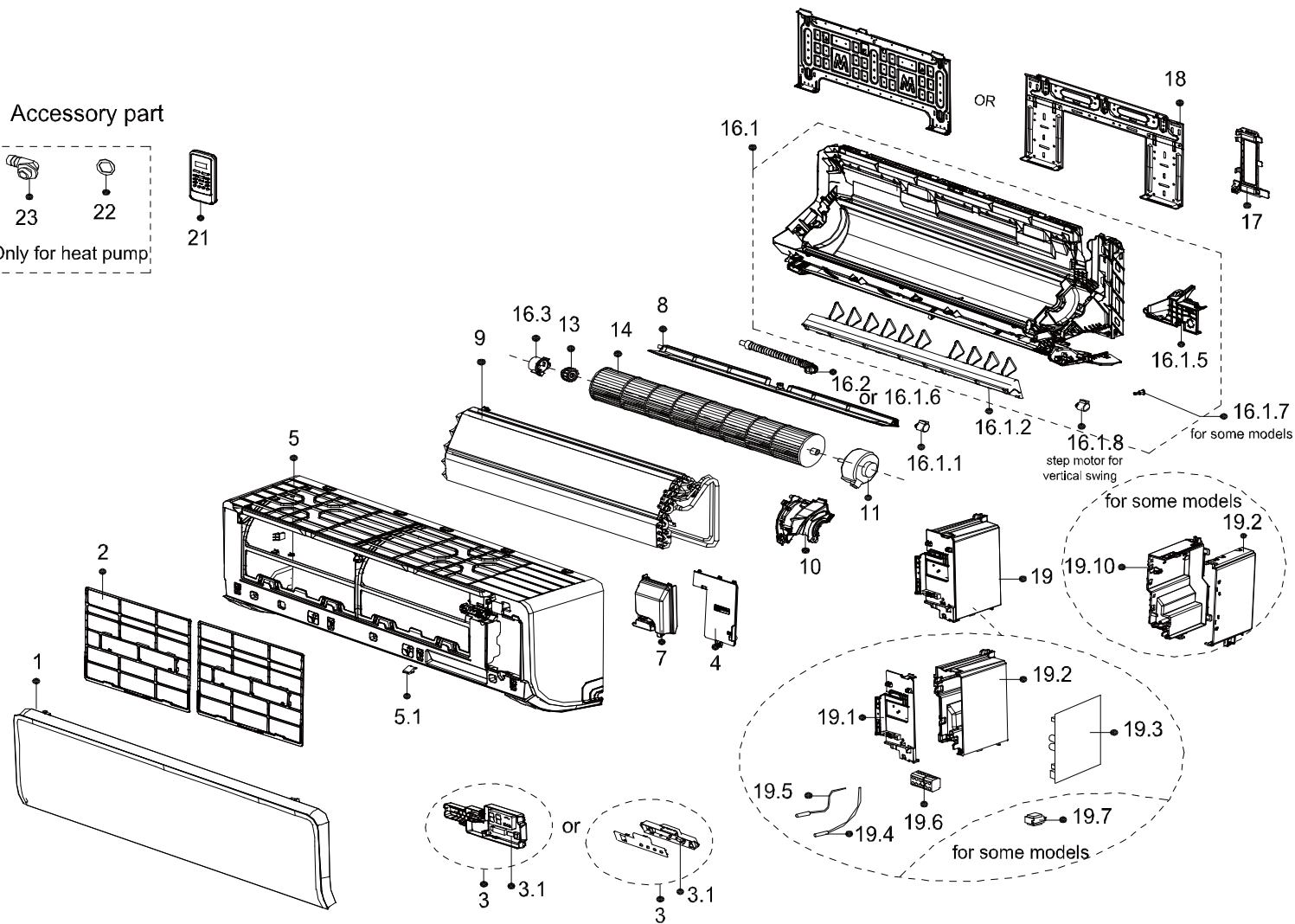

### Optional part

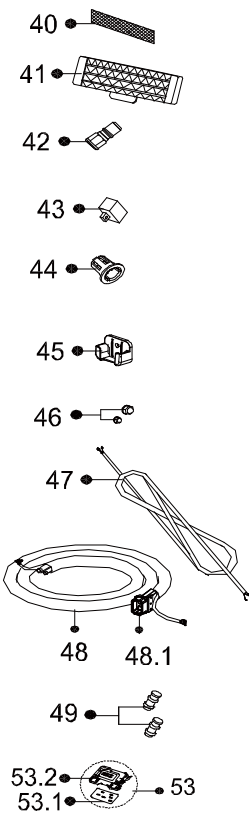

### Exploded View

产品编码(Product model) :	22022011015522
客户编码(Customer No) :	G0011405
客户型号(Customer model) :	KSH-12HRHI
订单编码(Order Product Code) :	62220-F3863601

EX_ID	Spare Parts Code	Part Name(CN)	Part Name(EN)	Qty.	Remark2	Part Status	Drawing No	MIN_ORDER_QTY	Long Term Material(Y or N)	High Rate of Replacement(Y or N)	SB Type	Replace Type	Remarks
1	12122000A87666	面板部件	Panel assembly	1		In Use	KAISAI-KFR35G/N1Y-AG14.1B-0101	1					
2	12100204000522	过滤网组件	Filter filter subassembly	2		In Use	CE-KFR35G/N1Y-AB-5	1					
3	17222000A61779	外销分体显示盒组件	Display box subassembly	1		In Use	CAKR-KFR23G/AG.JD.GN.WXXS.XK1.2(88/DLJC/400XC/WIFI)						
3.1	17122000052326	外销分体显示板组件	Display board subassembly	1		In Use	CAKR-KFR23G/N1Y-AG(88+WIFI).JD.GN.WXXS.XS2.1(88/DLJC)						
4	12122000024739	电器盖板	Cover of electrical equipment	1		In Use	KFR-35G/BP3DN1Y-VA200-3A	1					
5	12122000025543	面框部件	Panel frame assembly	1		In Use	CE-KFR35G/N1Y-AG21.2	1					
5.1	12122000013139	螺钉盖	Screw Cap	1		In Use	SA-KF35G/N1Y-AF.2-2	1					
7	12122000025064	接线盖板	Cover board for wiring	1		In Use	EU-KFR35G/BP3N8Y-FA-1	1					
8	12122000025544	导风板部件	Horizontal louver assembly	1		In Use	CE-KFR35G/N1Y-AG21.3	1					
9	15822000010276	蒸发器部件	Evaporator assembly	1		In Use	KFR-35G/BP2DN8Y-AG400(B3).ZL1	1					
10	12122000029503	电机盖	Fan motor cover	1		In Use	KFR-35G/BDN8Y-AG400(3)A-5	1					
11	11002015000150	无刷直流电机	Brushless DC Motor	1		In Use	ZKFP-13-8-4						
13	12622000000131	轴承座组件	Bearing components	1		In Use	ZCZZJ-01	1					
14	12100102000576	贯流风轮	Cross flow fan	1		In Use	GL-96*608-IN	1					
16	12122000025628	室内机底盘部件	Chassis assembly	1		In Use	KFR-35G/BP2DN8Y-AG400.1A	1					
16.1	12122000026444	室内机底盘部件	Chassis assembly	1		In Use	KFR-35G/BP2DN8Y-AG400.1.1A	1					
16.1.1	11002010000143	步进电机	Stepper motor	1		In Use	SM-24-19-16-8						
16.1.2	12122000025629	蜗舌条	vortex tongue bar	1		In Use	KFR-35G/BP2DN8Y-AG400.1.2A	1					
16.1.5	12122000024735	防鼠挡板	Anti mouse baffle	1		In Use	KFR-35G/BP2DN8Y-AG400.1-11						
16.1.6	12100501000032	出水喉	Drain hose	1		In Use	KFR-26G/BP2DN1Y-IC-10	1					
16.1.7	12122000000344	防电轴(本色,POM)	Insulated axis	1		In Use	EU-KFR35G/BP3N1Y-1A.1-1	1					
16.1.8	11002010A00014	步进电机	Stepper motor	1		In Use	SM-24-19-16-89						
16.3	12122000000350	轴承座套	Bearing holder	1		In Use	ZCZT-01	1					
17	12122000012943	配管压板	pipe clamp board	1		In Use	CE-KFR35G/N1Y-AB-14	1					
18	12222000000018	室内机安装板	Installation plate	1		In Use	CE-KFR26G/N1Y-AB.8	1					
19	17222000036981	外销分体室内电控盒组件(中低端)	Electronic control box subassembly (Mid-and low-end)	1		In Use	EU-KFR35G/BP3NXY-AGBU(RD0).JD.GN.NXNK.NP1.2(SW-1W/EE1/GW)	1					
19.1	12122000025621	电控盒盖(BMC)	Cover of electronic control box (BMC)	1		In Use	KFR-35G/BP2DN8Y-AG400.9B-1A	1					
19.2	12122000024733	电控盒	Electronic control box	1		In Use	KFR-35G/BP2DN8Y-AG400.9A	1					
19.3	17122000054904	外销分体室内主控板组件	Main control board subassembly	1		In Use	EU-KFR35G/BP3NXY-AGBU(RD0).JD.GN.NXNK.NP1.4(ION/V/SW-1W/EMC/EE1/GW)						
19.4	11201007003424	室温传感器	Room Temperature Sensor	1		In Use	CGQ-WD/SW4100-L350-XHBCP2BL-P300-HT1.0						
19.5	11201007003447	管温传感器	Pipe Temperature Sensor	1		In Use	CGQ-WD/GW4100-L350-XACP2-P250						
19.6	17400401000576	接线座	Wire joint	1		In Use	JXZ-AD5ZG2-A	1					
21	17317000A58345	订单遥控器	Remote controller	1		In Use	RG10A1(F2S)/BGEF	1					
22	12600701000039	密封圈	seal ring	1		In Use	KC25B.4-8A	1					
23	12100509000061	出水接管	Drain hose	1		In Use	CSJG-1	1					
40	12100204000685	冷触媒过滤网	Air freshening filter	1		In Use	KFR-23G/AY.1-10	1					
40	12100207000136	HEPA网	High efficiency particulate air filter	1		In Use	KFR-23G/IY.1-14A	1					
43	17400609000580	正负离子发生器	Ion generator	1		In Use	ZFLZ-20	1					
45	12122000029201	遥控器安装支架组件	Bracket of remote Controller	1		In Use	RG10ZJ-1	1					

46	15500406000010	铜螺母	Copper nut	1	A01=6.35mm(1/4in);B02=9.52mm(3/8in);C03=12.7mm(1/2in);D04=15.9mm(5/8in);E05=19mm(3/4in);F07=22mm(7/8in);	In Use	TLM-B02	0	N	N			
46	15500406000016	铜螺母	Copper nut	1	A01=6.35mm(1/4in);B02=9.52mm(3/8in);C03=12.7mm(1/2in);D04=15.9mm(5/8in);E05=19mm(3/4in);F07=22mm(7/8in);	In Use	TLM-A01	0	N	N			