

20

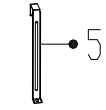

21

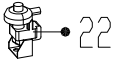

23

24

25

26

27

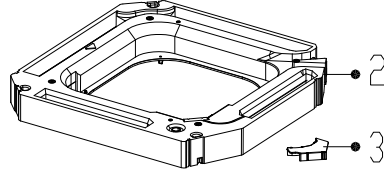
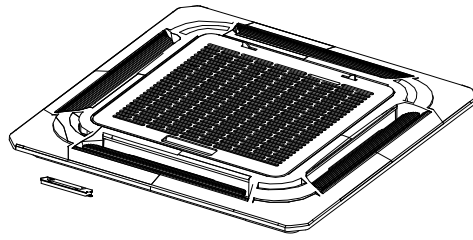

3

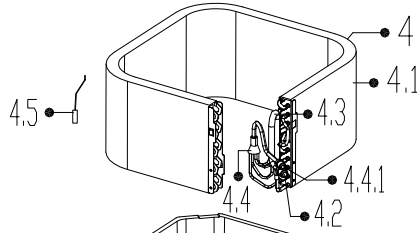

4.5

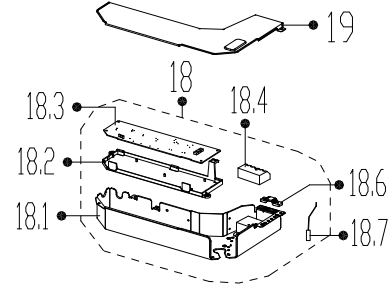
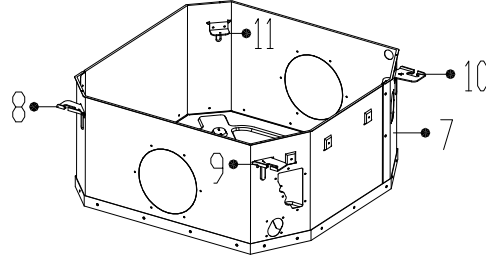
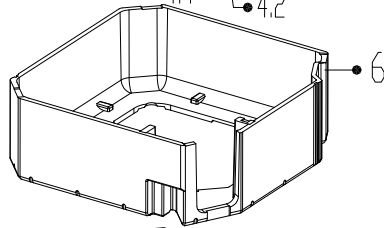

19

37 (for some models)

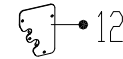
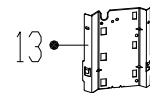
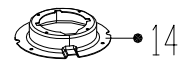
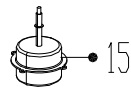
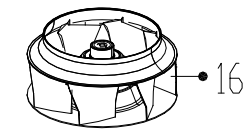
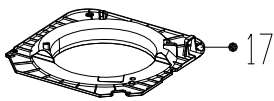

## Exploded View

Product code :  
Customer model :

22022311000291  
KCA3I-09HRF32

| EX_ID | Spare Parts Code | Part Name(EN)                      | Qty. | Min Shipments | Part Status | Remarks | Long Term Material(Y or N) | High Rate of Replacement(Y or N) | Option Parts |
|-------|------------------|------------------------------------|------|---------------|-------------|---------|----------------------------|----------------------------------|--------------|
| 2     | 1282250000017    | Water collector assembly           | 1    |               | In use      |         |                            |                                  |              |
| 3     | 1212250000022    | Wire box                           | 1    |               | In use      |         |                            |                                  |              |
| 4     | 15822500001720   | Evaporator Assembly                | 1    |               | In use      |         |                            |                                  |              |
| 4.1   | 15822500001721   | Evaporator                         | 1    |               | In use      |         |                            |                                  |              |
| 4.2   | 15122500002898   | Evaporator inlet pipe subassembly  | 1    |               | In use      |         |                            |                                  |              |
| 4.3   | 15122300000765   | Evaporator outlet pipe subassembly | 1    |               | In use      |         |                            |                                  |              |
| 4.4   | 15122500002898   | Evaporator inlet pipe subassembly  | 1    |               | In use      |         |                            |                                  |              |
| 4.5   | 11201007000070   | Pipe temperature sensor            | 1    | 0             | In use      |         | N                          | Y                                |              |
| 5     | 12222500000093   | Evaporator fixing hanger           | 1    |               | In use      |         |                            |                                  |              |
| 6     | 12822500000005   | Base foam subassembly              | 1    |               | In use      |         |                            |                                  |              |
| 7     | 12222500000224   | Chassis Assembly                   | 1    |               | In use      |         |                            |                                  |              |
| 8     | 12222500000191   | Hook                               | 1    |               | In use      |         |                            |                                  |              |
| 9     | 12222500000192   | Hook                               | 1    |               | In use      |         |                            |                                  |              |
| 10    | 12222500000190   | Hook                               | 1    |               | In use      |         |                            |                                  |              |
| 11    | 12222500000193   | Hook                               | 1    |               | In use      |         |                            |                                  |              |
| 12    | 12122500000330   | Pipe fixing board subassembly      | 1    | 0             | In use      |         | N                          | N                                |              |
| 13    | 12222500000197   | Evaporator connecting board        | 1    |               | In use      |         |                            |                                  |              |
| 14    | 12222500000199   | Fan motor base                     | 1    |               | In use      |         |                            |                                  |              |
| 15    | 11002015000069   | Brushless DC Motor                 | 1    |               | In use      |         |                            |                                  |              |
| 16    | 12100103000089   | centrifuge fan                     | 1    |               | In use      |         |                            |                                  |              |
| 17    | 12122500000425   | Ventilation ring                   | 1    |               | In use      |         |                            |                                  |              |
| 18    | 17222300001508   | Electronic control box subassembly | 1    |               | In use      |         |                            |                                  |              |
| 18.1  | 12222500000165   | Electronic control box             | 1    |               | In use      |         |                            |                                  |              |
| 18.2  | 12122500000029   | Insulation plate                   | 1    |               | In use      |         |                            |                                  |              |
| 18.3  | 17122300001972   | Main control board subassembly     | 1    |               | In use      |         |                            |                                  |              |
| 18.4  | 17400401000097   | Wire joint                         | 1    | 10            | In use      |         | Y                          | Y                                | No           |
| 18.6  | 12200202000004   | Wire clamp                         | 1    |               | In use      |         |                            |                                  |              |

|      |                |                              |   |   |        |  |   |   |
|------|----------------|------------------------------|---|---|--------|--|---|---|
| 18.7 | 11201007000283 | Room temperature sensor      | 1 |   | In use |  |   |   |
| 19   | 12222500000209 | control box cover            | 1 |   | In use |  |   |   |
| 20   | 17317000A42320 | Remote controller            | 1 |   | In use |  |   |   |
| 21   | 17400511000015 | Water Level Switch           | 1 |   | In use |  |   |   |
| 22   | 11001010000063 | Induction pump               | 1 |   | In use |  |   |   |
| 23   | 12622500000005 | Drain pump rubber washer     | 1 |   | In use |  |   |   |
| 24   | 12622500000003 | Drain pump rubber washer     | 1 | 0 | In use |  | N | N |
| 25   | 12222500000352 | Drain pump installation base | 1 |   | In use |  |   |   |
| 26   | 12622500000012 | Rubber tube                  | 1 | 0 | In use |  | N | N |
| 27   | 12100510000019 | Drain pipe                   | 1 |   | In use |  |   |   |
| 38   | 12117000002114 | Bracket of remote Controller | 1 |   | In use |  |   |   |
| 43   | 12026200A00001 | Accessory kit                | 1 |   | In use |  |   |   |
| 44   | 15500406000016 | Copper nut                   | 1 | 0 | In use |  | N | N |
| 45   | 15500406000010 | Copper nut                   | 1 | 0 | In use |  | N | N |